



CenterScanner Plus

Professional drill guide for accurate positioning of entry and exit points when drilling walls and ceilings

This highly accurate drill guide consists of a transmitter and a receiver and provides safe alignment of the drill channel when drilling through walls and ceilings up to 150 cm. Easily visible LED indicators and acoustic signals provide the location. Highly accessible marking aids in the sender and receiver provide the centring. The required drilling depth can be determined up to 200 cm using the integral LCD display. The TX sender with metal and voltage detection effectively prevents drilling errors. A visual and acoustic warning is sent when foreign objects are detected.

- Simple and precise alignment of the drill channel
- Precise location of the entry and exit points using LED indicators
- Highly accessible marking aids in the sender and receiver provide the centring
- Determination of the required drilling depth up to 200 cm
- TX receiver with integral metal and voltage detection to avoid drilling errors
- Optical and acoustic warning when foreign objects detected

TECHNICAL DATA

LED Display	RECV: 3 x 7 segments
Measuring Depth	Positioning RECV: 2 - 150 cm wall thickness Depth display RECV: 2 - 200 cm drilling depth
Accuracy	typically 3% of measured depth
Detection Range AC	2 cm
Power Supply	RECV: 3 x 1.5V LR03 (AAA) / TX: 3 x 1.5V LR03 (AAA)
Operating Time	RECV: approx. 20 hours / TX: approx. 12 hours
Operating Conditions	RECV: -30°C ... 40°C / TX: -20°C ... 40°C, max. humidity 85% rH, no condensation, max. working altitude 2000 m above sea level
Storage Conditions	-20°C ... 60°C, max. humidity 85% rH
Dimensions (W x H x D)	75 mm x 172 mm x 28 mm
Weight	410 g (RECV and TX incl. batteries)

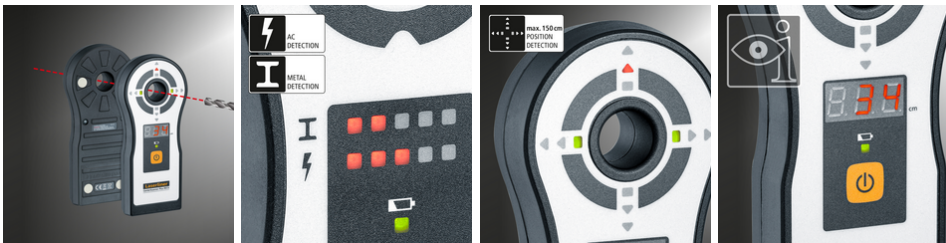
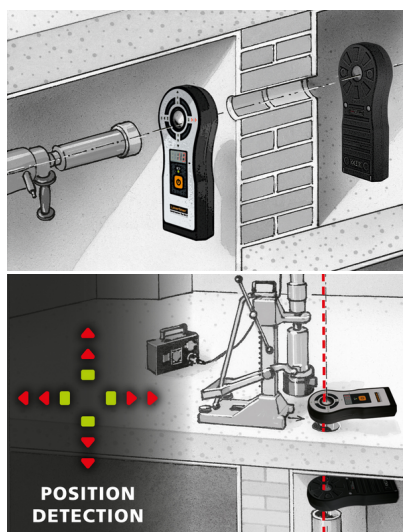

6x AAA



SCOPE OF DELIVERY



Item No. 075.300A

GTIN (EAN) 402156369926

SU 2