



DuoView Camera



Camera unit for VideoFlex G3 and G4 with additional side camera and lighting

This camera unit can be used together with VideoFlex G3 as well as G4 and is suitable for inspecting hard-to-reach places, for example wall cavities, shafts, brickwork or in motor vehicles. It has a front and a side camera for quickly changing the view at the touch of a button. High-brightness object illumination with four high-performance LEDs on the front camera and two LEDs on the side camera ensure meaningful images even in poor conditions. The camera head and cable are waterproof.

- Camera unit for VideoFlex
- Front and side camera for quick change of view at the touch of a button
- 4 high-performance, high-intensity LEDs on the front camera for powerful object lighting and 2 LEDs on the side camera
- For inspecting highly inaccessible locations such as cavities, shafts, masonry or in vehicles
- Waterproof camera head and cable
- Compatible with G3/G4

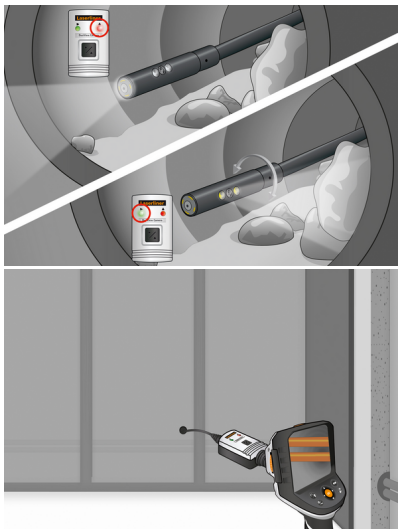

TECHNICAL DATA

Diameter Camera Head	10 mm
Number of Led Lights	Front: 4 / Side: 2
Camera Resolution	640 x 480 pixels
Field of View (FOV)	57°
Depth of Focus (DOF)	Front: 3 ... 5 cm / Side: 1 ... 5 cm
Diameter of Probe	6 mm
Length of Probe	1 m
Minimum Bending Radius	50 mm
Operating Conditions	0°C ... 60°C, max. humidity 20 ... 90% rH, no condensation, max. working altitude 4000 m above sea level
Storage Conditions	-20°C ... 80°C, max. humidity 80% rH
Dimensions (W x H x D)	1100 mm x 30 mm x 24 mm
Weight	144 g #

